



Easyfire

Standalone biomass pellet boiler

ferroli

DESIGN

ESSENTIAL AND PLEASANT AESTHETIC, SMALL SIZE

If the humanity is in balance with the resources of nature, the respect for the environment will be possible.

Ferrol, always sensitive to the ecological themes, has identified the best synthesis between the nature and the comfort efficiency!

Easyfire provides top performances and very low smoke emissions.



> THE RANGE

5 MODELS

17 - 24 - 29 - 35 - 39

HEAT INPUT FROM 17 KW TO 38,3 KW



Every little detail has been carefully and stylishly designed:

- Very compact pellet boiler for central heating, with an integrated automatically burner
- The door handle lies flush with the front panel
- The thermally insulated top and side panels have no visible screws
- The turbulator shaker knobs are partly hidden
- Thermal insulation of the casing panels limits heat loss and keeps external surfaces cool.
- Easyfire boilers incorporate a large capacity pellet hopper (70 kg for models 29 - 35 - 39 and 50 kg for models 17 - 24).

COMBUSTION CHAMBER

BIG SURFACE AREA HEAT EXCHANGER FOR MAXIMUM EFFICIENCY

- Large volume flue gas reversal collectors for uniform temperature and speed
- Extremely low emissions thanks to accurately calibrated combustion and vermiculite combustion chamber walls
- Turbulators for reduced flue gas speed and more efficient heat exchange
- Combustion chamber with fully water-jacketed front face to eliminate thermal stress between combustion parts and external panels
- Combustion chamber with fully insulated top (hottest) section; latest generation insulation prevents heat loss to outside
- Stable and rigid mounting thanks to built-in base and thick steel panels
- Two inspection doors with closure adjustment brackets
 1. Fire door with flame viewing window
 2. Ash bin door for removing and emptying the large ash bin, complete with overpressure safety valve for protection against explosion
- Fully inspectable: in addition to the inspection doors, the flue gas collectors can also be inspected:
 1. at the bottom, through the side and centre plugs
 2. at the top, by removing the cover panel

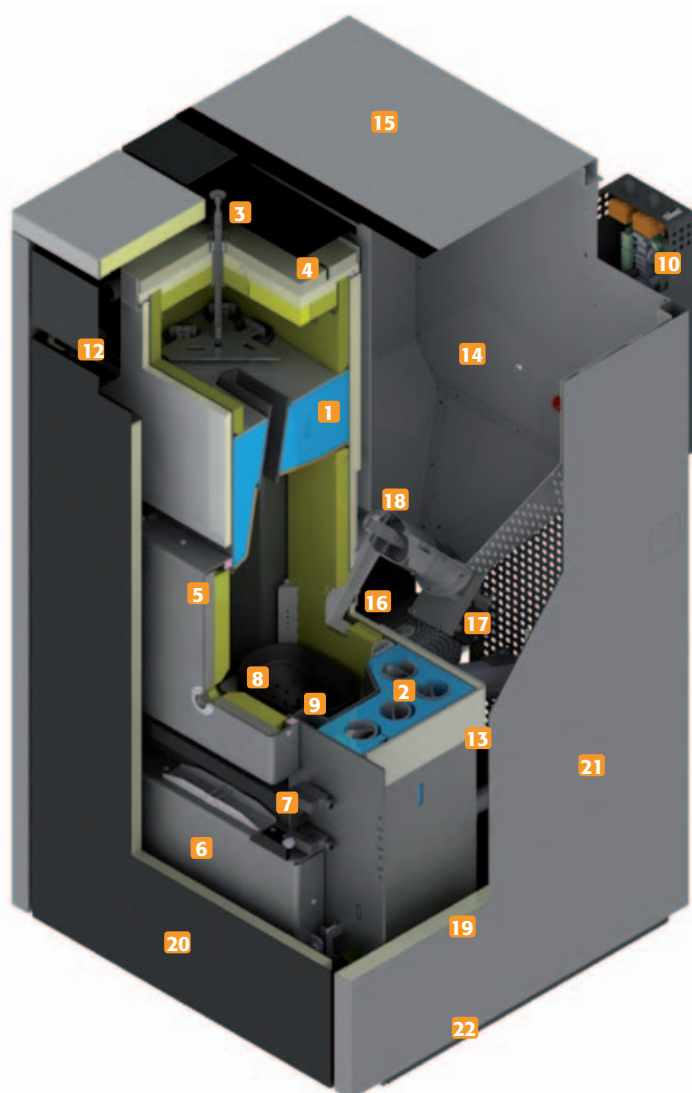

KEY

- 1 Electro-welded steel water heating chamber
- 2 Flue gas-water heat exchange tubes
- 3 Turbulator shaker rod
- 4 Insulated cover for water heating chamber
- 5 Thermally insulated fire door with flame viewing window
- 6 Large ash bin
- 7 Overpressure safety valve
- 8 Firebox with mini-collectors for secondary air
- 9 Cast iron grate
- 10 Pull-out electrical and electronic component box
- 12 control panel faceplate
- 13 Primary air inlet with flow meter
- 14 Pellet hopper with protective grille
- 15 Pellet hopper filling panel
- 16 Pellet chute
- 17 Pellet feed screw gear motor
- 18 Pellet feed screw
- 19 Thermally insulated side panel
- 20 Thermally insulated front door
- 22 One-piece base with water heating chamber and 4 adjustable feet

> **FOCUS ON** PRODUCT PLUSES

> **BURNER**

COMPOSED BY:

- Handle brazier that guarantees an optimal distribution as well as the distribution of primary air with secondary angle little collectors in vertical position
- Cast iron brazier with large perforated surface
- Increased intake pipe with flow meter



> **LOADING SYSTEM**

COMPOSED BY:

- Motoreductor
- Steel auger
- Self-lubricant bushes



> **FLUE GAS EXHAUST**

COMPOSED BY:

- Tube D100
- New cast iron volute chamber fixed on the rear wall
- Ejector powered by D180



> **TURBOLATORS AND CLEANING SYSTEM**

The flue gas loop is equipped by steel turbulators. They increase thermal exchange for a very high efficiency.

On the top of turbulators there are two knob for an easy manual cleaning operation of smoke pipes.



> ADVANTAGES

EASY OPERATIONS

- To clean the thermally insulated top section of the boiler, simply lift off the top panel (which is held in place by simple clips - no screws)
- To clean the bottom section, simply open the ash bin door and remove the ash bin and central plug. There is no need to remove the side panels
- The flue gas extractor can be removed easily, through the central panel on the rear of the boiler
- The electrical and electronic component box can be removed and replaced without having to remove the side panel.

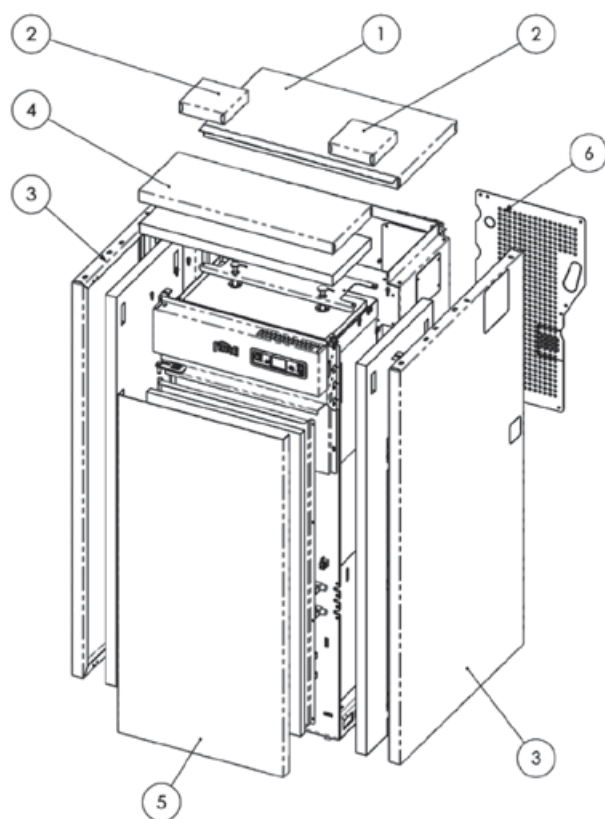

Removing the boiler cladding

KEY

- 1 Pellet hopper door
- 2 Central middle covers
- 3 Side panel
- 4 Front cover
- 5 Insulated outer door
- 6 Rear panel

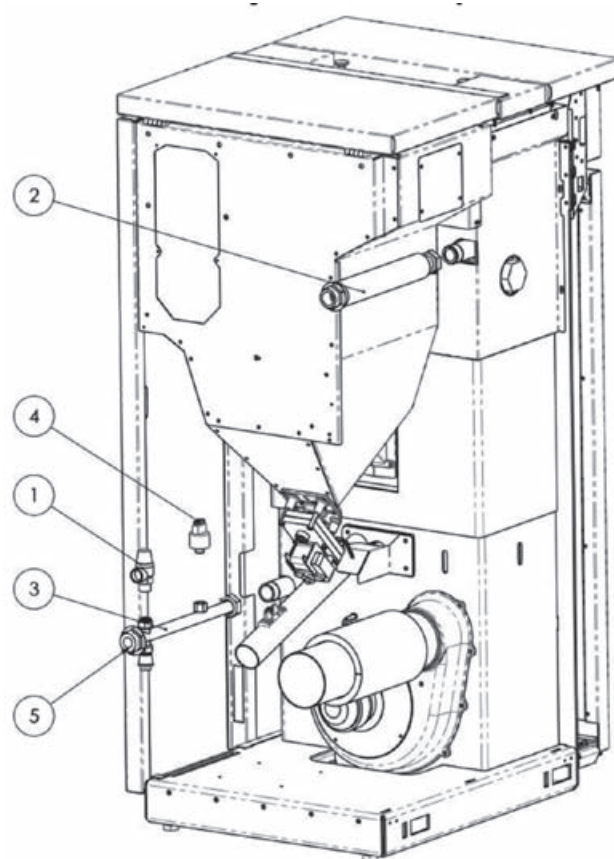

Standard hydraulic components

KEY

- 1 Pressure relief valve
- 2 Delivery pipe with connections 1"
- 3 Return pipe with connection 1"
- 4 Pressure transducer
- 5 System filling/discharge connection 1/2"

> CONTROL PANEL / SYSTEM CONNECTIONS

CONTROL PANEL F047 AND SYSTEM CONNECTION EXAMPLES

CONTROL PANEL

In the upper front panel there is the control panel (mod. F047) to display at every moment the state of operation of the boiler. Control panel has a complete interface display and a set of keys for an very easy boiler setting. Electronic control on board is complete with the free plugs to connect main elements of a central heating system (pumps, system probes, temperature room control...)

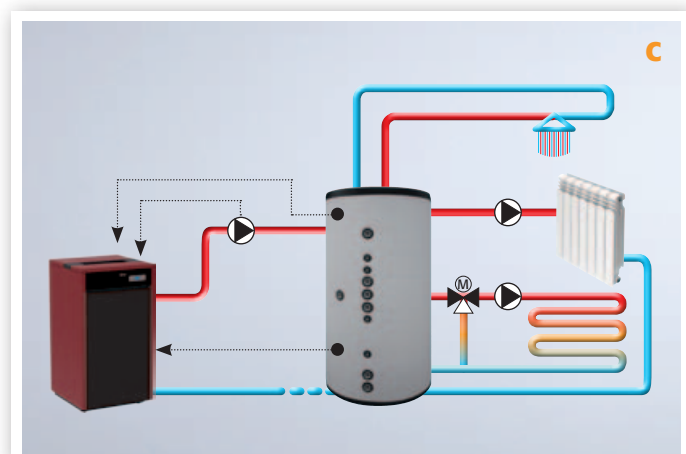
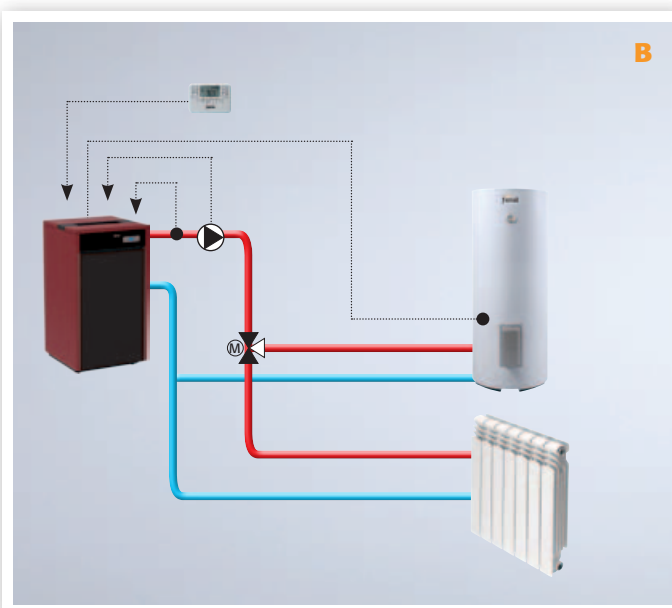
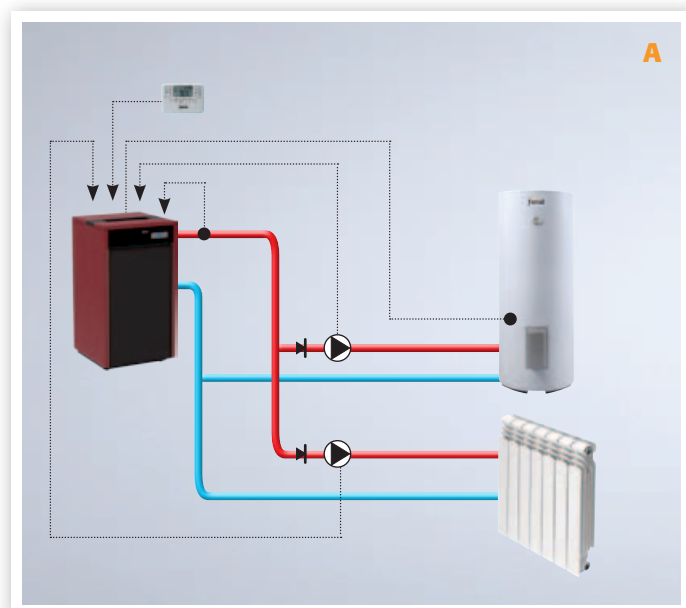
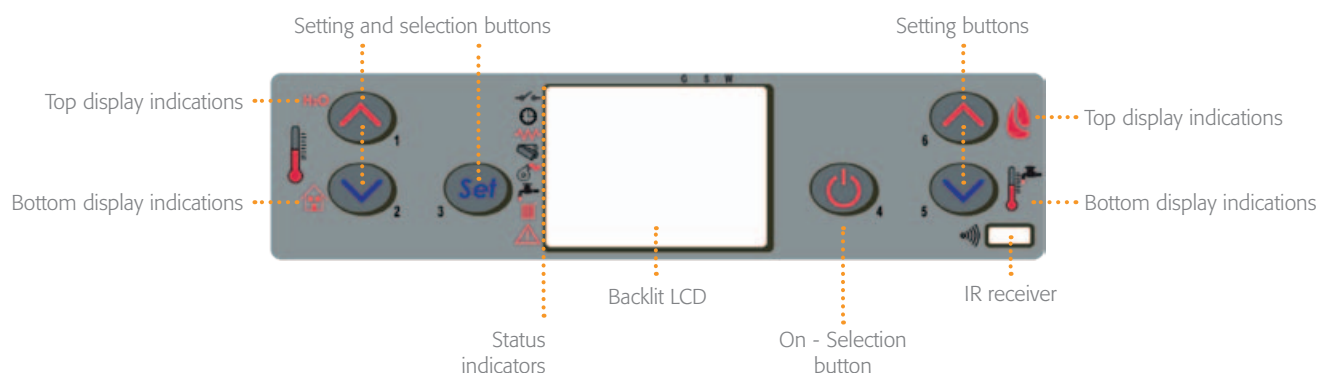

- A**) Direct combination heating system with two dedicated pump for the heating system and the domestic hot water: two pumps, hot water probe, temperature room control
- B**) Direct combination heating system with a pump and three way valve for the heating system and domestic hot water: pump, 3 way valve, hot water probe, temperature room control
- C**) Indirect combination heating system, with a big tank of technical water: pump for the first water ring, max temperature probe, min temperature probe

> TECHNICAL SPECIFICATIONS

DIMENSIONS - TECHNICAL DATA

EASYFIRE MOD. 17 - 24

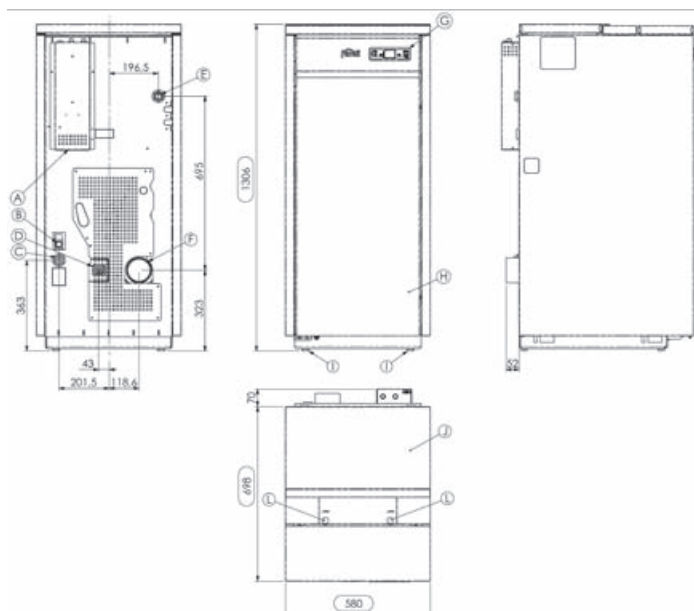

EASYFIRE MOD. 29 - 35 - 39

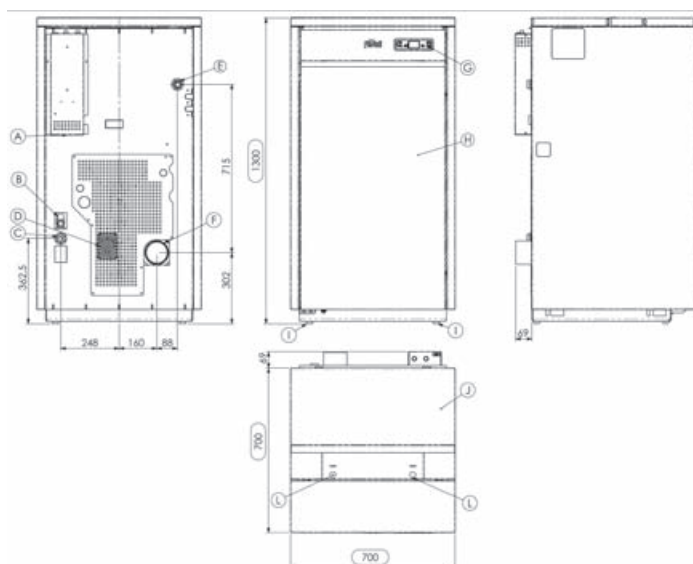
**KEY**

A Power cable connection **B** Overpressure water discharge (1/2" F - 3 bar) **C** Heating system return (1" M) **D** Combustion air inlet ø 50 mm
E Connection - delivery without pump (1" M) **F** Fume exhaust pipe connection Ø 100 mm **G** Control panel model F047 **H** Door to access fire door and ash box **I** Adjustable feet **J** Pellet hopper door **L** Turbulator shaker knob

MODEL		17	24	29	35	39
Body		Steel				
Combustion chamber		Steel				
Heat output	kW	17	23,2	29	34,4	38,3
Heat output water [H _{nom}] - [H _{red}]	kW	16,2-4,2	22-4,2	27,4-5,78	32,4-5,78	34,9-5,78
Fuel / hourly consumption at H _{nom} - H _{red}	kg/h pellets	3,5-0,91	4,8-0,91	6,0-1,32	7,1-1,32	7,9-1,32
CO emissions (10% O ₂) at H _{nom} - H _{red}	%	0,011-0,032	0,007-0,023	0,004-0,029	0,007-0,040	0,006-0,029
Dust emissions (13% O ₂) at H _{nom} - H _{red}	%	17,3-18,5	16,2-18,5	17,6-6,9	17,2-6,9	17,8-6,9
Flue gas exhaust temperature) at H _{nom} - H _{red}	°C	102,8-53,8	128,1-53,8	134,3-62,6	148,6-62,6	159,5-62,6
Efficiency) at H _{nom} - H _{red}	%	95,68-95,09	94,54-95,09	94,45-90,14	94,18-90,14	91,32-90,14
Flue draught	Pa	10-14	10-14	10-14	10-14	10-14
Flue gas exhaust diameter	mm	100	100	100	100	100
Power supply		230 V - 50Hz				
Power consumption		420-55		440-85		
Hopper capacity	kg	48	48	68	68	68
Water heating chamber capacity	l	25	25	30	30	30
Weight	kg	220	220	262	262	262
Dimensions	HxWxD	1306x580x698		1300x700x700		



NOTICE FOR DEALERS:

As part of its efforts to constantly improve its range of products, with the aim of increasing the level of customer satisfaction, the company stresses that the appearance, dimensions, technical data and accessories may be subject to variation.

Consequently, ensure that the customer is provided with up-to-date technical and/or sales documents.

Ferroli spa

37047 San Bonifacio (VR) Italy - Via Ritonda 78/A

tel. +39.045.6139411

fax +39.045.6100233

www.ferroli.com

export@ferroli.it